

# PRODUCT DESCRIPTION MANUAL

☐ ITEM REFERENCE    ☐ PROCESS MATERIAL    ☐ TORQUE    ☒ EXISTING AS PART OF

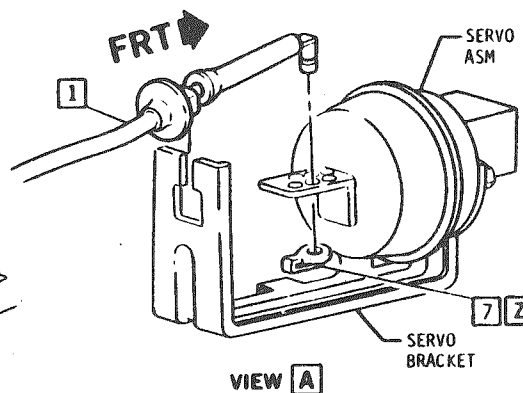
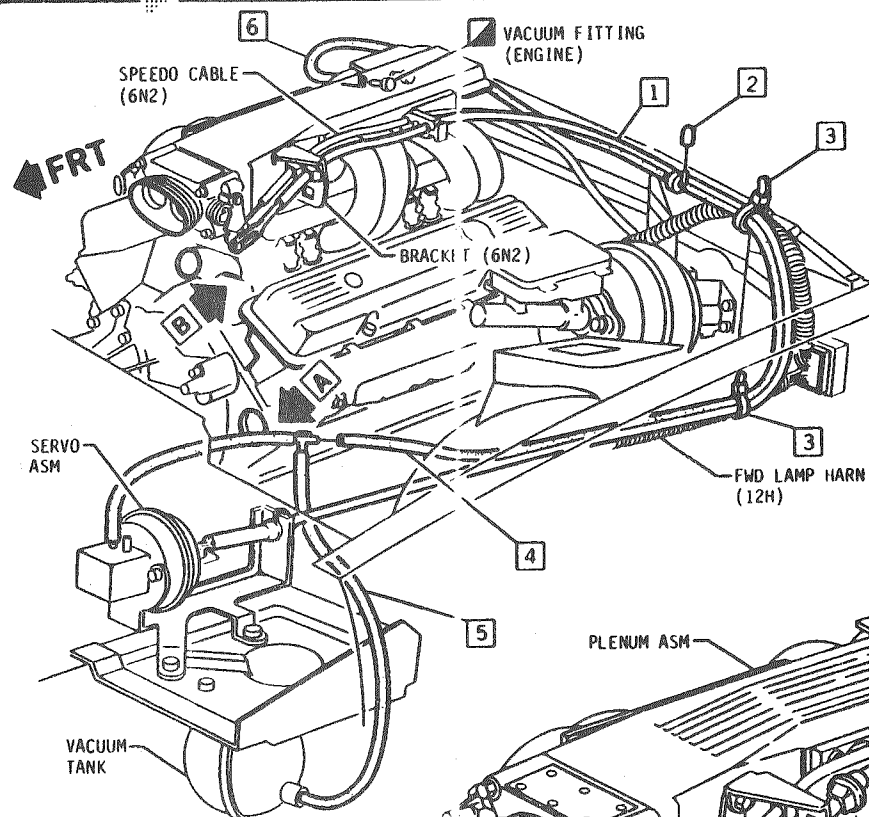

- |          |          |              |
|----------|----------|--------------|
| 14089491 | <b>1</b> | CABLE ASM    |
| 3928101  | <b>2</b> | CAP & C41    |
| 11501906 | <b>3</b> | STRAP        |
| 14068750 | <b>4</b> | HOSE ASM     |
| 14068728 | <b>5</b> | HOSE ASM     |
| 9436964  | <b>6</b> | HOSE         |
| 1247872  | <b>7</b> | RETAINER     |
| 9985377  | <b>A</b> | LUB 0.001 kg |

### CABLE ADJUSTMENT PROCEDURE

1. WITH CABLE [1] INSTALLED IN ENGINE BRACKET AND SERVO BRACKET, INSTALL CABLE OVER STUD ON LEVER SO STUD ENGAGES SLOT IN CABLE END. ASSEMBLE CABLE TO THROTTLE BODY LEVER STUD WITH RETAINER [7] AND RELEASE THROTTLE BODY LEVER.
2. PULL SERVO ASM END OF CABLE TOWARD SERVO WITHOUT MOVING THROTTLE BODY LEVER.
3. IF ONE OF THE SIX HOLES IN THE SERVO ASM TAB LINES UP WITH CABLE PIN, CONNECT PIN TO TAB WITH RETAINER [7].
4. IF A TAB HOLE DOES NOT LINE UP WITH THE PIN, MOVE THE CABLE AWAY FROM THE SERVO ASM UNTIL THE NEXT CLOSEST TAB HOLE LINES UP AND CONNECT PIN TO TAB WITH RETAINER [7].

**CAUTION** DO NOT STRETCH CABLE SO AS TO MAKE A PARTICULAR TAB HOLE CONNECT TO PIN. THIS WILL PREVENT ENGINE FROM RETURNING TO IDLE.

**Z** SEE UPC "OA" GENERAL INFORMATION  
FOR RETAINER INSTRUCTIONS.

**CAUTION** CABLE IS NOT TO BE KINKED OR DAMAGED IN ANY WAY DURING ASSEMBLY OPERATION.

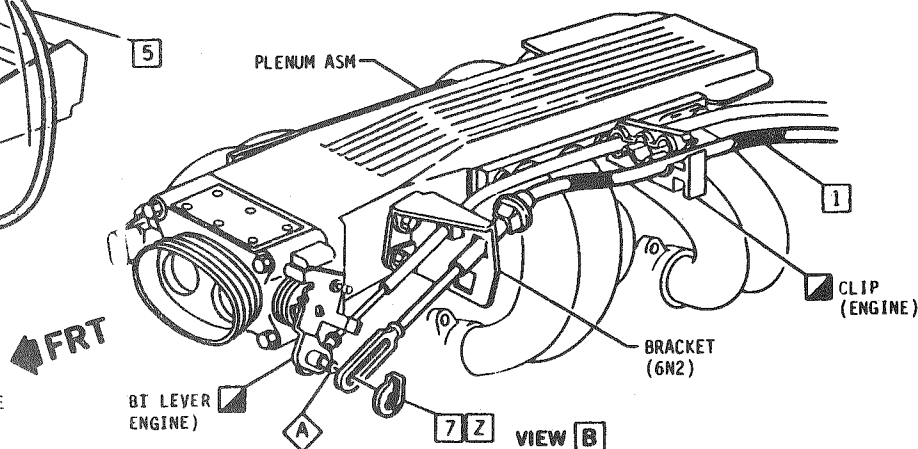

DYNAMIC (Instal) H-m	HAND (Instal.) H-m	DATE	SYM	REVISION	APPR	DR	CK	ASB GSE	DATE	DIV	1986 F PASSENGER 14089402			
									OR P KOCH	 CHEVROLET	TITLE	CRUISE CONTROL CABLE & HOSE ROUTING FA00 & K34 & LB9		
								CK J. McKenna AM						
								APPR S						
								APPR						
								APPR						
FULLY DRIVEN SEATED - NOT STRIPPED											REF ECA 41600 .NEW 17SEB4	I- 34443(S) L- L- L-	UPC 6N4	SHEET C4.1