

PRODUCT DESCRIPTION MANUAL

□ ITEM REFERENCE ◇ PROCESS MATERIAL ▲ TORQUE ▣ EXISTING AS PART OF

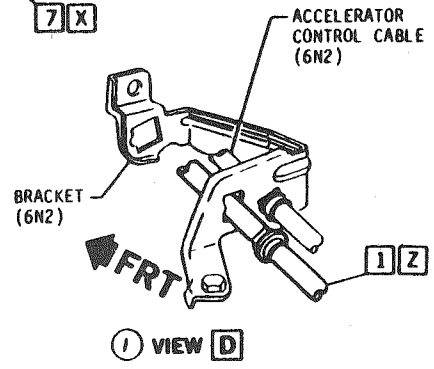
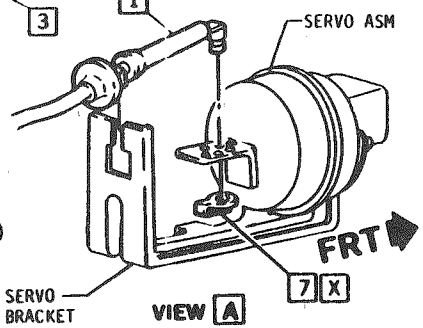
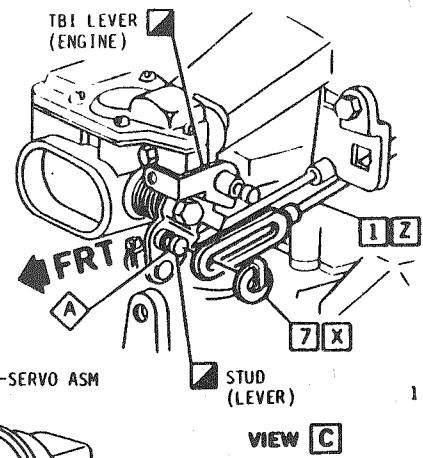
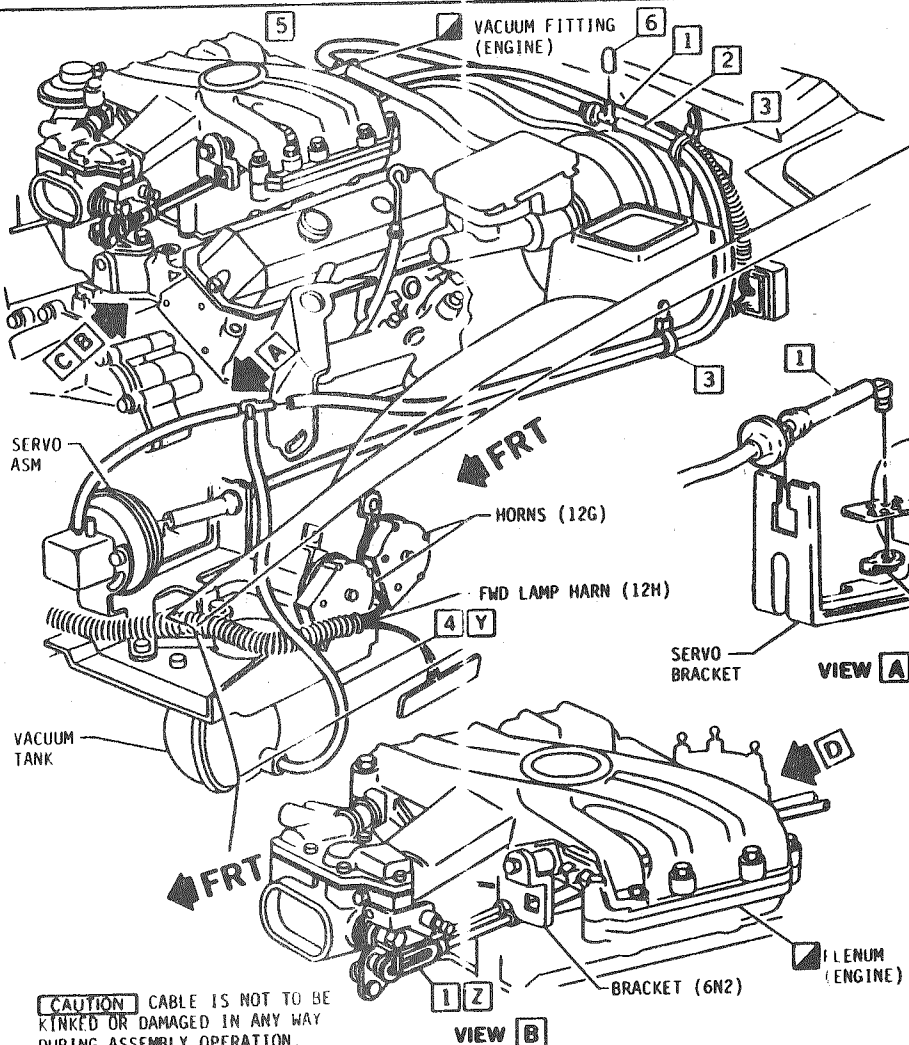

- 14089492 1 CABLE ASM
- 14068750 2 HOSE ASM
- 11501906 3 STRAP
- 14068728 4 HOSE ASM
- 9439819 5 HOSE
- 3928101 6 CAP & C40/C41
- 1247872 7 RETAINER
- 9985377 ▲ LUB 0.001 kg

CABLE ADJUSTMENT PROCEDURE

1. WITH CABLE 1 INSTALLED IN ENGINE BRACKET AND SERVO BRACKET, INSTALL CABLE OVER STUD ON LEVER SO STUD ENGAGES SLOT IN CABLE END. ASSEMBLE CABLE TO THROTTLE BODY LEVER STUD WITH RETAINER 7 AND RELEASE THROTTLE BODY LEVER.
2. PULL SERVO ASM END OF CABLE TOWARD SERVO WITHOUT MOVING THROTTLE BODY LEVER.
3. IF ONE OF THE SIX HOLES IN THE SERVO ASM TAB LINES UP WITH CABLE PIN, CONNECT PIN TO TAB WITH RETAINER 7.
4. IF A TAB HOLE DOES NOT LINE UP WITH THE PIN, MOVE THE CABLE AWAY FROM THE SERVO ASM UNTIL THE NEXT CLOSEST TAB HOLE LINES UP AND CONNECT PIN TO TAB WITH RETAINER 7.

CAUTION DO NOT STRETCH CABLE SO AS TO MAKE A PARTICULAR TAB HOLE CONNECT TO PIN. THIS WILL PREVENT ENGINE FROM RETURNING TO IDLE.

- X SEE UPC "0A" GENERAL INFORMATION FOR RETAINER INSTRUCTIONS.
- Y ROUTE HOSE 4 OVER FORWARD LAMP HARNESS.
- Z ROUTE CABLE 1 UNDER PLENUM AND INSTALL TO BRACKET.

CAUTION CABLE IS NOT TO BE KINKED OR DAMAGED IN ANY WAY DURING ASSEMBLY OPERATION.

DYNAMIC (Instal) N ^o	HAND (Instal) N ^o	DATE	SYM	REVISION	AUTH	DR	CK	ASST	APP	DATE	DR	APP	APP	APP	APP	REF	TITLE	UPC	SHEET
		15/10/79	1	VIEW D ADDED	41600	CU				09/09/79	R KOCH	S				ECA 41600 NEW 175E84	186 F PASSENGER CRUISE CONTROL CABLE & HOSE ROUTING FA00 8LB8 8K34	1L-34443(S)	6N4 C4

▲ FULLY DRIVEN, SEATED & NOT STRAPPED

B C X R O P