

1988-91 "F" BRAKE CALIPER/REAR

Click on the image for a close-up (Note: image is large)

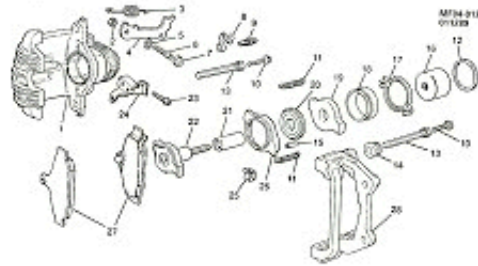

M154013

1988-91 "F" BRAKE CALIPER/REAR

1. 4.895 HOUSING, W/Piston Kit	19132832	14. 4.895 BOLT, Guide Pin	14087582
4.895 HOUSING, W/Piston Kit	19132831	15. N.S. PLUNGER (1.2)	
2. 6.190 NUT, Hex (M6x1.25x1.8)		16. 4.895 PISTON, Cal	10132843
3. 6.151 SPRING, Pk Brk Lvl Rtr	22821850	17. N.S. WETTER (1.2)	
4. 4.391 BEVEL, Pk Brk	19132838	18. N.S. BOLT (1.2)	
5. 4.895 LVL, Parking Brk Lever	19132854	19. N.S. ADJUSTING COLLAR (1.2)	
6. 4.895 Spring	19132844	20. N.S. BOLT (1.2)	
7. 4.895 Pk Brk Lvl Pin	19132839	21. N.S. BUSHING (1.2)	
8. 4.895 CAP, Parking Brk Lev Flange	19132843	22. N.S. CLAMP ROD (1.2)	
9. 4.895 CAP, Clip Bleeder Screw	14087580	23. 4.654 BOLT, Clip Anchor Plate	10132839
10. 4.895 SCREW, Clip Bleeder	14087588	24. 4.768 BRACKET, Pk Brk Ck/Brk	10132839
11. 4.895 BOLT, Guide Pin (2)	14087568	25. 4.783 BRACKET, Pk Brk Guide	10132837
12. 4.897 SEAL, Clip Piston (2)	14087582	26. N.S. PRELOAD SPRING (1.2)	
13. 4.898 PIN, Guide	14087568	27. N.S. WETTER (1.2)	
		28. N.S. SHOCK & SPRING	
		29. 4.654 PLATE, Anchor	10132832

NOTE 1: Adjusting Collar Rtr Brk Kit 10132838 group 4.658 inch 18, 17, 16, 18, 20, 21, 22, 25, 26
 NOTE 2: Pad Paper Kit 19132836 1988-90 10132840 1990-91 Group 3 201 Pad Kit 1027
 NOTE 3: Parking Brake Repair Kit 10132838 Group 4.658 inch 10, 11, 15, 20, 25, 26

Jump to....

Diagrams & Part Number Tables Copyright © General Motors Corporation. All Rights Reserved. Reproduced by Permission.